



## Manual Welding Torch M-AR 500W, water cooled

### Technical Data according to EN 60 974-7

Rating:

CO <sub>2</sub> :	500A
Mixed Gas M21:	450A
Duty cycle:	@100%
Wire-Ø:	0,8 – 1,6mm

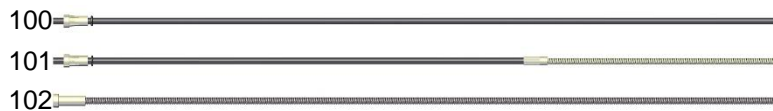
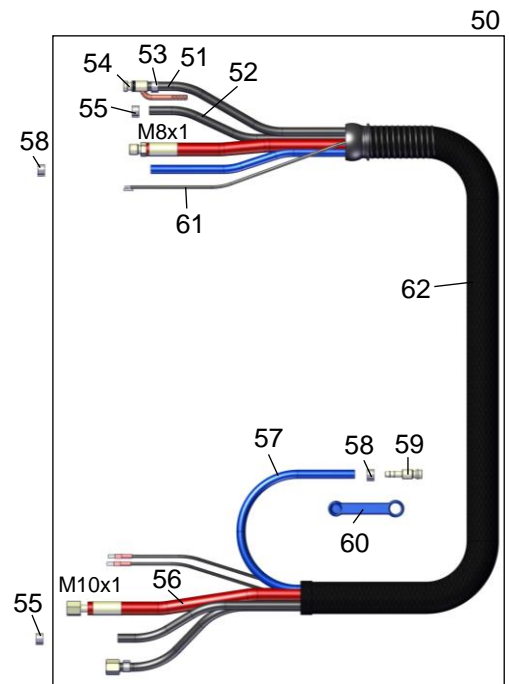
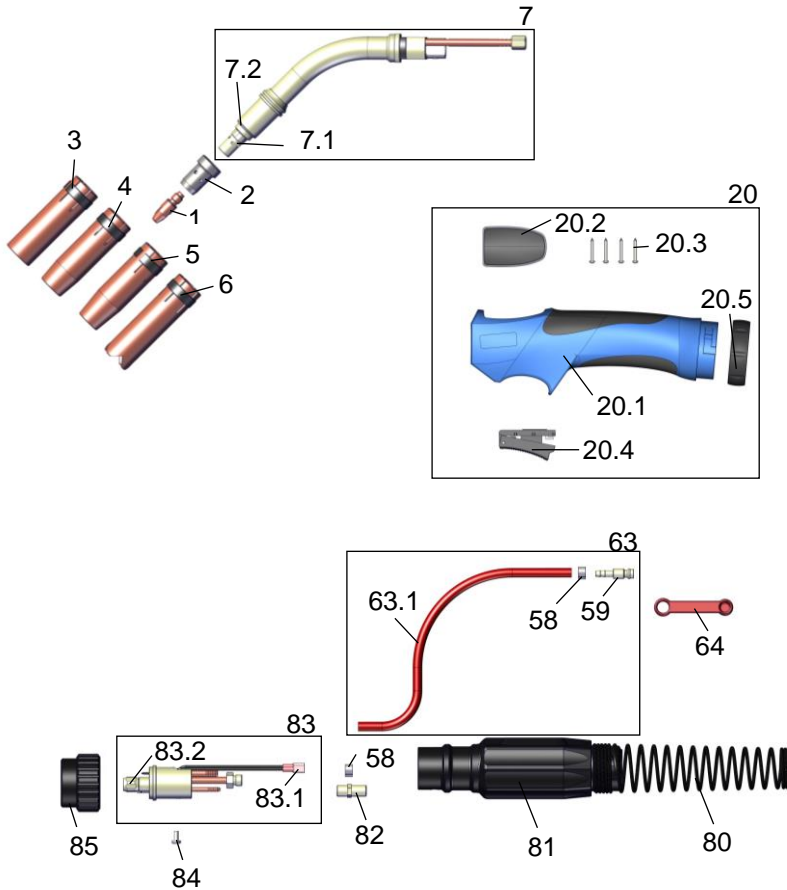

### Part Number for complete Welding Torch

Standard configuration tip Ø 1,2mm

	3m	4m	5m
M-AR 500W cpl. with blue handle, Euro-connection (Steel Liner 2,0x4,5mm)	2510M30200	2510M40200	2510M50200
M-AR 500W cpl. with grey handle, Euro-connection (Steel Liner 2,0x4,5mm)	2510M30100	2510M40100	2510M50100



## Spare Part List

Pos.	Part No.	Description	Pos.	Part No.	Description
1	24106xx	Contact Tip M8x30, ø in mm / ECu <sup>1</sup> (PU=10)	50	24139M30	Cable Assembly M-AR cpl. 3m
	24176xx	Contact Tip M8x30, ø in mm / CuCrZr (PU=10)		24139M40	Cable Assembly M-AR cpl. 4m
	24166xx	Contact Tip M8x30, ø in mm / Alu (PU=10)		24139M50	Cable Assembly M-AR cpl. 5m
	22506xx	Contact Tip M6x28, ø in mm / ECu (PU=10)	51	25146M30	Outer Liner M-AR cpl. 3m
	22576xx	Contact Tip M6x28, ø in mm / CuCrZr (PU=10)		25146M40	Outer Liner M-AR cpl. 4m
	22566xx	Contact Tip M6x28, ø in mm / Alu (PU=10)		25146M50	Outer Liner M-AR cpl. 5m
	<i>Tips available in ø 0.8/0.9/1.0/1.2/1.4/1.6 mm</i>		52	0550111	Gas Hose Ø 4,0x1,5 (PU=100m)
	<i>Please insert wire diameter at xx.</i>		53	03211181	Single Ear Clamp D=11,8 (PU=100)
	<i>Example: ø 1,2 mm is 12; Part No.: = 2410612</i>		54	21201027	Wire-Gas-Connector
2	2410702	Gas Diffuser, white <sup>1</sup> (PU=5)	55	03210871	Single Ear Clamp D=8,7 (PU=100)
	2410700	Gas Diffuser, black (PU=5)			
	2410702K	Gas Diffuser, ceramic (PU=5)	56	2414130	Power Cable cpl. 3m
3	2410801	Gas Nozzle, cylind NW19 L=76mm (PU=5)		2414140	Power Cable cpl. 4m
4	2410802	Gas Nozzle, con. <sup>1</sup> NW16 L=76mm (PU=5)		2414150	Power Cable cpl. 5m
5	2410803	Gas Nozzle, tapered NW14 L=76mm (PU=5)	57	0550105	Water Hose blue Ø 5,0x1,5, (PU=100m)
6	2410805	Spot Welding Gas NW20 L=76mm (PU=5)	58	03211001	Single Ear Clamp D=10,0 (PU=100)
7	2510M100	Swan Neck M-AR 400W	59	2990800	Water Hose Nipple (PU=10)
7.1	2410408	Tip Adapter M8 short <sup>1</sup> (PU=5)	60	45050339	Water Stop blue (PU=10)
	2410418	Tip Adapter M8 long (PU=5)	61	24144M30	Control Cable M-AR cpl. 3m
	2410406	Tip Adapter M6 short (PU=5)		24144M40	Control Cable M-AR cpl. 4m
	2410416	Tip Adapter M6 long (PU=5)		24144M50	Control Cable M-AR cpl. 5m
7.2	2410202	Insulating Washer (PU=10)	62	24145M30	Cover Hose M-AR cpl. 3m
				24145M40	Cover Hose M-AR cpl. 4m
20	2114001K	MIG-Handle AR-K2, blue cpl. neutral top		24145M50	Cover Hose M-AR cpl. 5m
	2114001K1	MIG-Handle AR-K2, grey cpl. neutral top	63	2414705	Water Outlet Hose cpl. 0,55m
20.1	2114001	MIG-Handle AR-K2, blue, left + right half	63.1	0550108	Water Hose red Ø 5,0x1,5 (PU=100m)
	21140012	MIG-Handle AR-K2, grey, left + right half	64	45050340	Water Stop red (PU=10)
20.2	2114007	Neutral top, AR-K2			
20.3	2114012	Screw for Handle (PU=20)			
20.4	2114006	Trigger cpl. AR-K2			
20.5	2114002	Nut for Handle AR-K2			

<sup>1</sup> Included in standard configuration



Pos.	Part No.	Description	Pos.	Part No.	Description
80	2411611	Cable Support Spring	100	34120X0	PTFE-Liner 2,0x4,0mm / X <sub>m</sub> red
81	2411600S1	Plug Housing, without nut		34727X0	PTFE-Liner 2,7x4,7mm / X <sub>m</sub> yellow
82	2411501	Threaded Nipple		35120X0	Carbon-PTFE-Liner 2,0x4,0mm / X <sub>m</sub> black
83	2411505	Gun Plug Body with Spring Loaded Pins		35127X0	Carbon-PTFE-Liner 2,7x4,7mm / X <sub>m</sub> black
83.1	2155100	Female Electrical Connector, insulated (PU=20)		35220X0	PA-Seele 2,0x4,0mm / X <sub>m</sub> anthrazit
83.2	2151501	Liner Positioner Nut		35323X0	PA-Liner 2,3x4,7mm / X <sub>m</sub> anthracite
84	0040601	Screw (PU=20)		35327X0	PA-Liner 2,7x4,7mm / X <sub>m</sub> anthracite
85	2151700	Plug Nut	101	34120X0K	Combi-PTFE-Liner 2,0x4,0mm / X <sub>m</sub> red
				34727X0K	Combi-PTFE-Liner 2,7x4,7mm / X <sub>m</sub> yellow
				35120X0K	Combi-Carbon-PTFE-Liner 2,0x4,0mm / X <sub>m</sub> black
				35127X0K	Combi-Carbon-PTFE-Liner 2,7x4,7mm / X <sub>m</sub> black
				35320X0K	Combi-PA-Liner 2,0x4,0mm / X <sub>m</sub> anthracite
				35323X0K	Combi-PA-Liner 2,3x4,7mm / X <sub>m</sub> anthracite
				35327X0K	Combi-PA-Liner 2,7x4,7mm / X <sub>m</sub> anthracite
			102	34520X1	Steel Liner 2,0x4,5mm / X <sub>m</sub> <sup>1</sup> blank
				34525X1	Steel Liner 2,5x4,5mm / X <sub>m</sub> blank

*Liners available in 3m/4m/5m. Please insert length at X.  
Example: Steel Liner 4m = 3452041*

<sup>1</sup> Included in standard configuration